

EXISTING BUILDINGS 2024

NOTES

- 1 The contents of this drawing are copyright.
- 2 Do not scale. Figured dimensions only to be used.
- 3 Contractors must verify all dimensions and report any discrepancies before putting work in hand or making any shop drawings.

LEGEND

GRID NORTH

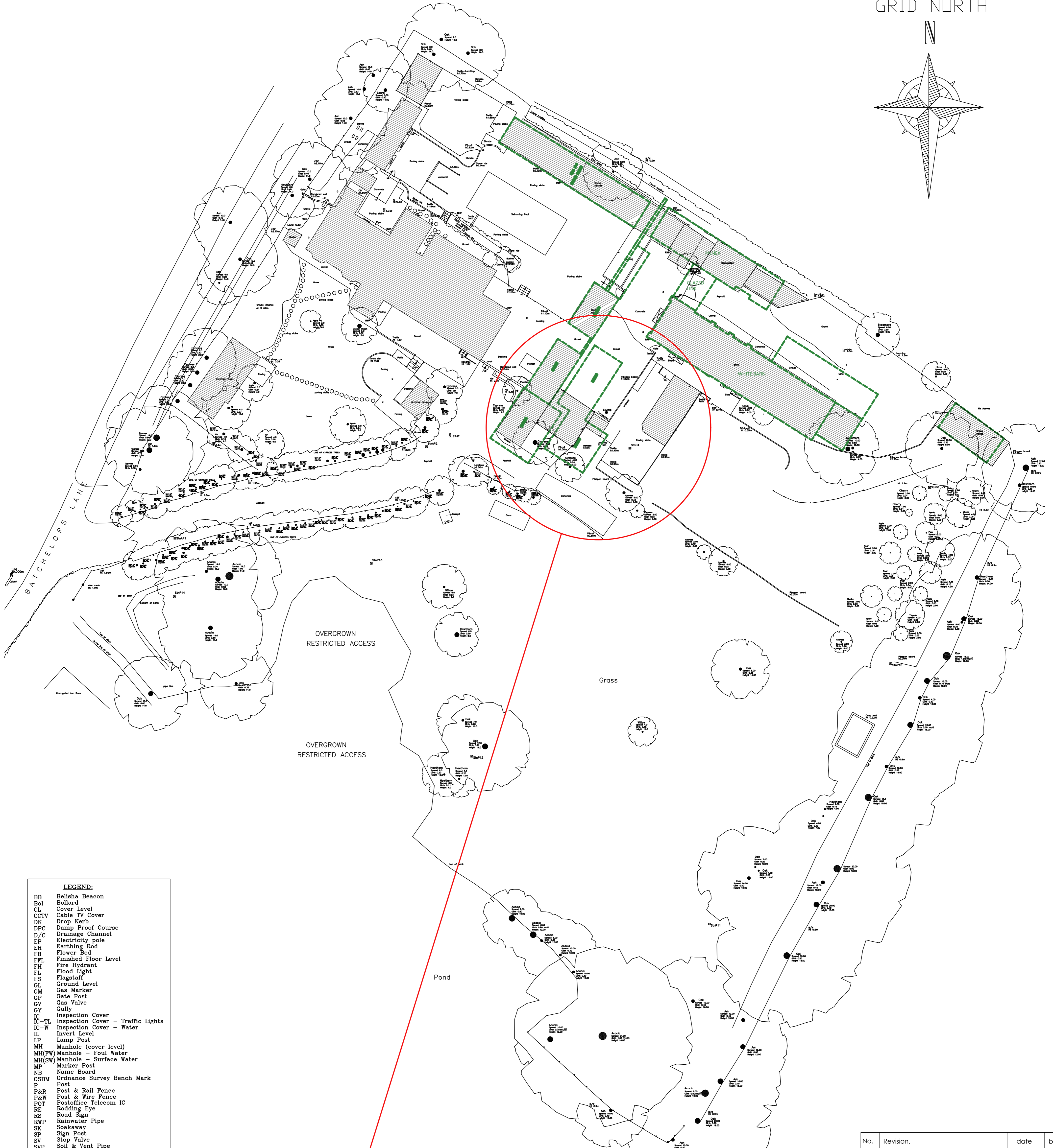
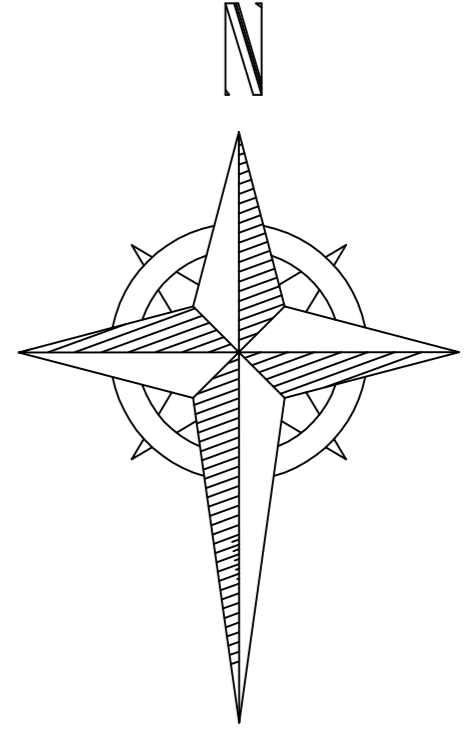

**LEGEND:**

|        |                                   |
|--------|-----------------------------------|
| BB     | Belisha Beacon                    |
| Bol    | Bollard                           |
| CL     | Cover Level                       |
| CCTV   | Cable TV Cover                    |
| DK     | Drop Kerb                         |
| DPC    | Damp Proof Course                 |
| D/C    | Drainage Channel                  |
| EP     | Electricity pole                  |
| ER     | Earthing Rod                      |
| FB     | Flower Bed                        |
| FFL    | Finished Floor Level              |
| FH     | Fire Hydrant                      |
| FL     | Flood Light                       |
| FS     | Flagstaff                         |
| GL     | Ground Level                      |
| GM     | Gas Marker                        |
| GP     | Gate Post                         |
| GV     | Gas Valve                         |
| GY     | Gully                             |
| IC     | Inspection Cover                  |
| IC-TL  | Inspection Cover - Traffic Lights |
| IC-W   | Inspection Cover - Water          |
| IL     | Invert Level                      |
| LP     | Lamp Post                         |
| MH     | Manhole (cover level)             |
| MH(FW) | Manhole - Foul Water              |
| MH(SW) | Manhole - Surface Water           |
| MP     | Marker Post                       |
| NB     | Name Board                        |
| OSBM   | Ordnance Survey Bench Mark        |
| P      | Post                              |
| P&R    | Post & Rail Fence                 |
| P&W    | Post & Wire Fence                 |
| POT    | Postoffice Telecom IC             |
| RE     | Rodding Eye                       |
| RS     | Road Sign                         |
| RWP    | Rainwater Pipe                    |
| SK     | Soakaway                          |
| SP     | Sign Post                         |
| SV     | Stop Valve                        |
| SVP    | Soil & Vent Pipe                  |
| TL     | Traffic Lights                    |
| TP     | Telegraph pole                    |
| TS     | Tree Stump                        |
| UNK    | Unknown Species                   |
| U/L    | Unable to lift MH cover           |
| WM     | Water Meter                       |
| WV     | Water Valve                       |
|        | Floor to ceiling ht               |

**FENCES:**

|     |                 |
|-----|-----------------|
| B/W | Barbed Wire     |
| CB  | Close Boarded   |
| CI  | Corrugated Iron |
| C/L | Chainlink       |
| CP  | Chestnut Paling |
| I/R | Iron Railings   |
| LR  | Larch Lap       |
| OB  | Open Boarded    |
| P&R | Post & Rail     |
| P&W | Post & Wire     |
| RW  | Retaining Wall  |

OFFICE & GARAGE - WHITE BARN

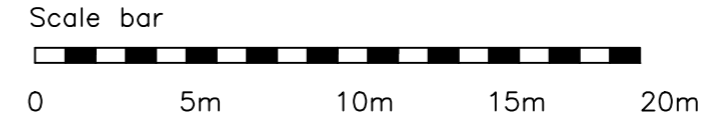
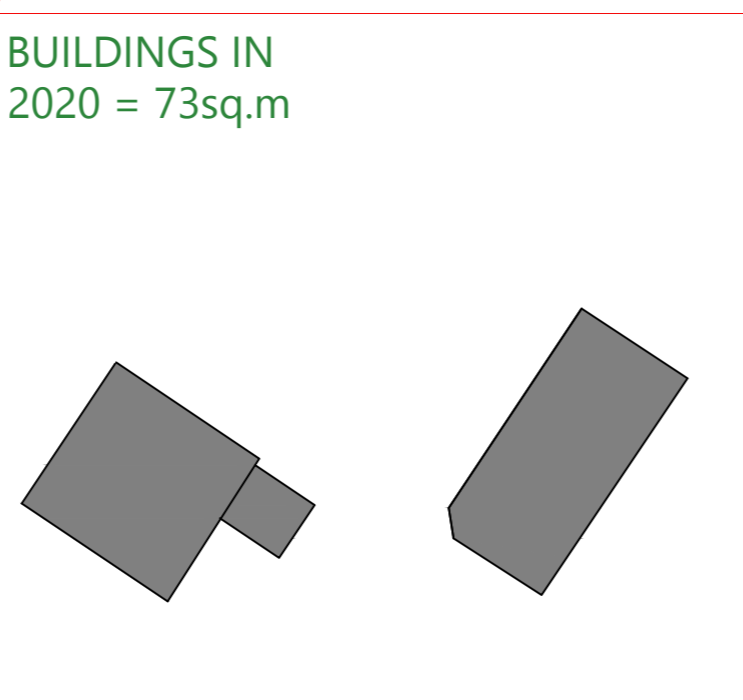
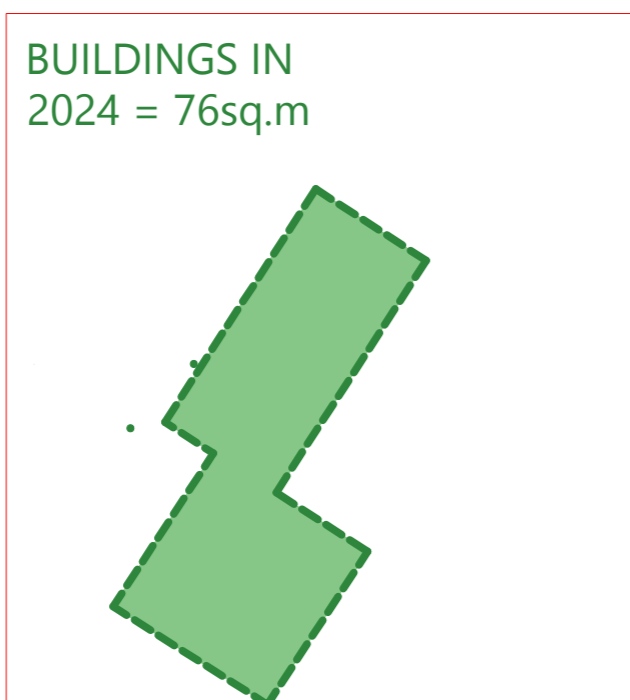

| No. | Revision. | date | by |
|-----|-----------|------|----|
|     |           |      |    |

SITE OVERLAY 2024 @:  
 ANCHOR PADDOCK  
 HOLTWOOD  
 WIMBORNE  
 DORSET  
 BH217DS

|                     |         |
|---------------------|---------|
| scale AS SHOWN @ A1 | checked |
| date DEC 2024       | drawn   |

**6547 / 002**

Anders Roberts Cheer Ltd

Chapel Studios, 14 Purewell,  
 Christchurch, Dorset, BH23 1EP

Tel: +44 (0) 1202 479919  
 E-mail: enquiries@andersroberts.com  
 Web: www.andersroberts.com

